

ADDITION & RENOVATION AT:  
**GANTNER ELEMENTARY SCHOOL**  
 99 ROOSEVELT AVENUE  
 ELMWOOD PARK, NJ 07407

ELMWOOD PARK PUBLIC SCHOOLS  
BOARD OF EDUCATION

<u>SUPERINTENDENT</u> Anthony Iachetti Ed.D.	<u>BOARD TRUSTEES</u> Keith Cannizzo
<u>BUSINESS ADMINISTRATOR/BOARD SECRETARY</u> Mark S. Jacobus	Doug DeMatteo
<u>BOARD PRESIDENT</u> Louise Gerardi	Chakib Fakhoury
<u>BOARD VICE PRESIDENT</u> Dorin Aspras	Elizabeth Mierzejewski
	Carrie Paretto
	Karen Pena
	Daniel Zoltek

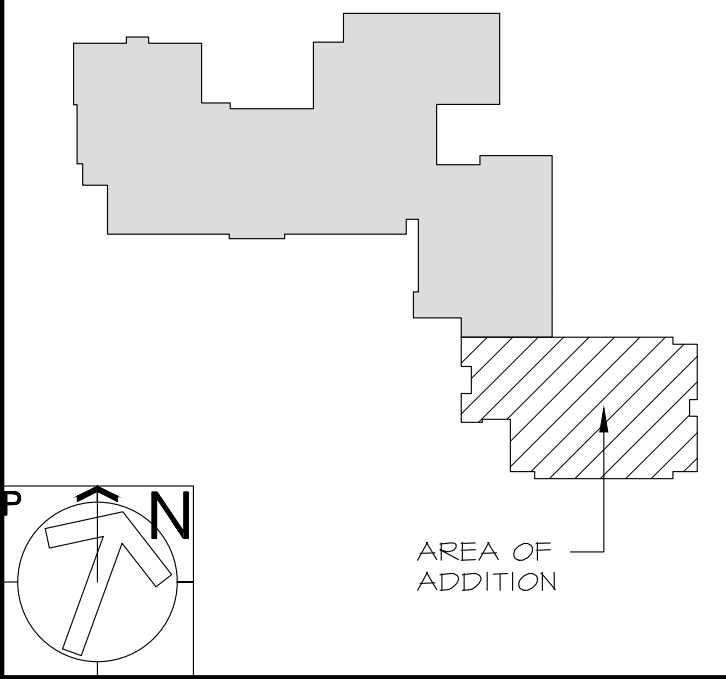

dicara | rubino architects  
 30 galesi drive, wayne, nj 07470  
 tel 973.256.0202

MEMBERS OF THE AMERICAN INSTITUTE OF ARCHITECTS

ALLEN BARNETT, AIA NJ # 21A101626200  
 ALLISON SROKA, AIA NJ # 21A102087600  
 RODERICK WATKINS, AIA NJ # 21A101625700

NOT VALID FOR BUILDING UNLESS SIGNED AND SEALED BY ARCHITECT

X \_\_\_\_\_  
 Board President of Schools

X \_\_\_\_\_  
 Superintendent of Schools

DO NOT SCALE THE DRAWINGS. USE CALCULATED DIMENSIONS.  
 SCALES INDICATED REFER TO SHEETS PRINTED AT FULL SIZE  
 AND ARE NOT APPLICABLE TO REDUCED DRAWINGS.

ADDITION & RENOVATION AT:

**GANTNER AVENUE  
 ELEMENTARY  
 SCHOOL**

99 ROOSEVELT AVENUE  
 ELMWOOD PARK, NJ 07407

ELMWOOD PARK PUBLIC SCHOOLS

TITLE SHEET

SCALE AS NOTED

REV.	DATE:	DRN	CHK	
	12/20/2023	CG	AB	ISSUED FOR BID

STATE PROJECT NO.  
 03-1345-070-23-3000

PROJECT NO. <b>4132A</b>	SHEET NO. <b>T1.0</b>
-----------------------------	--------------------------



**STRUCTURAL ENGINEER**

Harrison-Hamnett, P.C.  
 Consulting Structural Engineers  
 40 Knowles Street Pennington, New Jersey 08534  
 Ph: 609-818-1808 Fax: 609-818-1809

**MECHANICAL, ELECTRICAL,  
 PLUMBING ENGINEER**

**A&J Consulting  
 Engineering Services, P.C.**  
 164 Brighton Road, Clifton, NJ 07012  
 T: 973-777-9696 | F: 973-777-5528  
 W: anjengineer.com

**SITE ENGINEER**

**FPA  
 FRENCH & PARRELLO  
 ASSOCIATES**  
 Corporate Office  
 1800 Route 34, Suite 101  
 Wall, NJ 07719  
 732.312.9800  
 Regional Offices  
 Hackettstown, NJ  
 New York, NY

**CONSTRUCTION MANAGER**

**EPIC  
 MANAGEMENT**  
 136 Eleventh St.  
 Piscataway, NJ 08854