

ADDITION & RENOVATION AT:
SIXTEENTH ELEMENTARY SCHOOL
 73 SIXTEENTH AVENUE
 ELMWOOD PARK, NJ 07407

ELMWOOD PARK PUBLIC SCHOOLS
BOARD OF EDUCATION

<u>SUPERINTENDENT</u> Anthony Iachetti Ed.D.	<u>BOARD TRUSTEES</u> Keith Cannizzo
<u>BUSINESS ADMINISTRATOR/BOARD SECRETARY</u> Mark S. Jacobus	Doug DeMatteo
<u>BOARD PRESIDENT</u> Louise Gerardi	Chakib Fakhoury
<u>BOARD VICE PRESIDENT</u> Dorin Aspras	Elizabeth Mierzejewski
	Carrie Paretto
	Karen Pena
	Daniel Zoltek

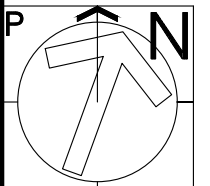
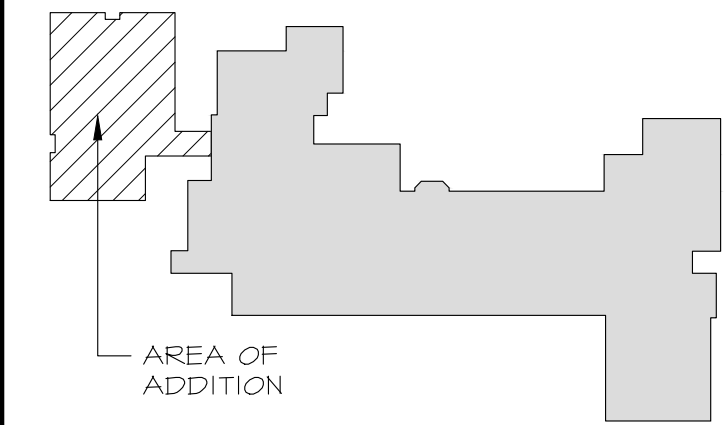

dicara | rubino architects
 30 galesi drive, wayne, nj 07470
 tel 973.256.0202

MEMBERS OF THE AMERICAN INSTITUTE OF ARCHITECTS

ALLEN BARNETT, AIA NJ # 21A101626200
 ALLISON SROKA, AIA NJ # 21A102087600
 RODERICK WATKINS, AIA NJ # 21A101625700

NOT VALID FOR BUILDING UNLESS SIGNED AND SEALED BY ARCHITECT

X _____
 Board President of Schools

X _____
 Superintendent of Schools

DO NOT SCALE THE DRAWINGS. USE CALCULATED DIMENSIONS.
 SCALES INDICATED REFER TO SHEETS PRINTED AT FULL SIZE
 AND ARE NOT APPLICABLE TO REDUCED DRAWINGS.

ADDITION & RENOVATION AT:
**SIXTEENTH AVE
 ELEMENTARY
 SCHOOL**
 73 SIXTEENTH AVENUE
 ELMWOOD PARK, NJ 07407
ELMWOOD PARK PUBLIC SCHOOLS
TITLE SHEET

SCALE AS NOTED

REV.	DATE:	DRN	CHK	
	12/20/2023	CG	AB	ISSUED FOR BID

STATE PROJECT NO.
 03-1345-090-23-1000

PROJECT NO. SHEET NO.
 4132C T1.0



STRUCTURAL ENGINEER

Harrison-Hamnett, P.C.
 Consulting Structural Engineers
 40 Knowles Street Pennington, New Jersey 08534
 Ph: 609-818-1808 Fax: 609-818-1809

**MECHANICAL, ELECTRICAL,
 PLUMBING ENGINEER**

**A&J Consulting
 Engineering Services, P.C.**
 164 Brighton Road, Clifton, NJ 07012
 T: 973-777-9696 | F: 973-777-5528
 W: anjengineer.com

SITE ENGINEER

**FPA
 FRENCH & PARRELLO
 ASSOCIATES**
 Corporate Office
 1800 Route 34, Suite 101
 Wall, NJ 07719
 732.312.9800
 Regional Offices
 Hackettstown, NJ
 New York, NY

CONSTRUCTION MANAGER

**EPIC
 MANAGEMENT**
 136 Eleventh St.
 Piscataway, NJ 08854